

532 COSMETIC VIEW

Ref.	Part No.	Description	Ref.	Part No.	Description
1	LG4811	Louvered Grille, 48 x 11	85	6110010	Bolt, #10-24 x 1/2" Flat Head UC
2	4280440	Unit Shroud Assembly	86	3540420	Door Hinge w/Pin, Bottom RH
3	6200230	Screw, #8-18 x 1/2" Hex Head		3540430	Door Hinge w/Pin, Bottom LH
4	2210701	Main Frame Angle	87	4200790	Light Diffuser Replacement Components; Fre
5	6200230	Screw, #8-18 x 1/2" Hex Head	88	3600830	Wire Shelf
6	1807300	Breaker Strip, 6' Length - NOTE: Must be cut to length	89	3410820	Freezer Basket/IM Bucket Front
7	3050020	Light Socket, 3/4 Double	90	3411070	Ice Bucket
8	3030040	Light Bulb, Long/Narrow; 40 Watt	91	3410820	Freezer Basket/IM Bucket Front
9	6200140	Screw, #8-15 x 3/8" Truss HD	92	3600950	Drawer Glass Retainer
10	0164550	Back Cover and Shroud	93	3500260	Freezer Drawer Glass
11	0232880	Freezer Duct/Evaporator Cover	94	NLA	Freezer Basket - See 4180880
12	6200710	Screw, #8-18 x 3/8" Fillister HD	95	3430080	Roller Bushing
13	1807300	Breaker Strip, 6' Length - NOTE: Must be cut to length	96	3421110	Crisper Roller
14	6220350	Shelf Support	97	6200730	Screw, #10-16 x 3/4" PH Flat HD UC
15	4180830	Ice Bucket Carriage Assembly	98	4180880	Basket Assembly, Fre
16	3410931	Ice Bucket Slide, Right	99	6200700	Screw, #6-20 x 5/8" PH Flat HD SS
	3410932	Ice Bucket Slide, Left	100	6220320	Screw Grommet
17	6200010	Screw, #10-12 x 3/4" Pan HD	101	3410971	Freezer Basket Retainer, RS
18	3030040	Light Bulb, Long/Narrow; 40 Watt	102	4180900	Crisper Drawer Assembly
19	3050010	Light Socket, 3/4 Single	103	4151100	Crisper Tray Assembly
20	6200090	Screw, #8-15 x 1-3/4" Truss HD	104	3411021	Crisper Drawer
21	3500310	Lower Light Diffuser	105	3411041	Crisper Glass Front
22	6200730	Screw, #10-16 x 3/4" PH Flat HD UC	106	3411051	Vent Slide
23	3421160	Basket Slide Roller	107	3 411031	Crisper Drawer Front
	3421170	Freezer Basket Slide Roller, Wide	108	3411160	Ref Roll-Out Bskt Divider
24	3430080	Roller Bushing	109	1302000	Rear Crisper Seal
25	6200450	Screw, #8 x 1" Type AR Flat	110	4151070	Crisper Glass Assembly
26	4180971	Freezer Basket Slide Assy - Right	111	2301701	Front Crisper Seal
	4180972	Freezer Basket Slide Assy - Left	112	6200700	Screw, #6-20 x 5/8" PH Flat HD SS
27	4110032	Left Base Assembly	113	6220320	Screw Grommet
28	3570020	Rear Leveling Leg, #18-3/8 x 1-1/2"	114	3411002	Refrigerator Roll-Out Basket Retainer, LH
29	3570050	Leveling Leg, #18-3/8 x 1"	115	3411001	Refrigerator Roll-Out Basket Retainer, RH
30	0164810	Kickplate, 3.25 x 47.5 - Vented	116	4180860	Basket Assembly, Ref Roll-out
31	6200050	Screw, #10-12 x 1/2" Pan HD	117	3500290	Refrigerator Roll-Out Basket Glass
32	3570030	Leveling Rod, 26-3/4"	118	3600930	Refrigerator Roll-Out Basket Glass Retainer
33	1807300	Breaker Strip, 6' Length - NOTE: Must be cut to length	119	3410900	Refrigerator Roll-Out Basket Front
34	1807200	Breaker Strip, Mullion- 6' Length - NOTE: Must be cut to length	120	4180800	Shelf Assembly, Ref Roll-out Basket
35	1807200	Breaker Strip, Mullion- 6' Length - NOTE: Must be cut to length	121	4180770	Glass Shelf Assembly
36	1807300	Breaker Strip, 6' Length - NOTE: Must be cut to length	122	4200810	Light Diffuser/Fan Shroud Replacement Components; Ref
37	4110031	Right Base Assembly	123	3410972	Freezer Basket Retainer, LS
38	3550460	White Cap plug	124	3450270	E-Ring / Retaining Ring
39	4180940	Crisper Slide Assy; Center	125	0200710	Refrigerator Evaporator Cover
40	6200450	Screw, #8 x 1" Type AR Flat	126	4120490	Main Frame Extrusion, LS
41	6200140	Screw, #8-15 x 3/8" Truss HD	127	3012580	Control Panel, Ref
42	6200450	Screw, #8 x 1" Type AR Flat	128	3410950	Freezer Control Panel Frame
43	6200010	Screw, #10-12 x 3/4" Pan HD	129	0211390	Light Diffuser Retainer
44	6240050	Flat Washer, 5/16"	130	0232670	Light Diffuser Retainer, Fre
45	4180931	Crisper Slide Assy, RS	131	NLA	Refrigerator Roll-Out Basket - See 4180860
	4180932	Crisper Slide Assy, LS	132	4180980	Ice Bucket Assembly
46	6200730	Screw, #10-16 x 3/4" PH Flat HD UC	133	NLA	Refrigerator Shelf Glass - See 4180770
47	3421110	Crisper Roller	134	0164870	Kickplate Support
48	3430080	Roller Bushing	135	3601111	Freezer Shelf Ladder RS
49	6200740	Screw, #10-32 x 11/16" PH Flat HD UC		3601112	Freezer Shelf Ladder LS
50	3421100	Crisper Roller	136	3012660	Control Panel, Fre
51	3430080	Roller Bushing	137	0165760	Switch Enclosure
52	3550450	Hex Insert	138	4110333	Base Assembly (w/rollers) - Right or Left
53	3601081	Cabinet Shelf Ladder RS	139	6110520	Adjusting Screw
	3601082	Cabinet Shelf Ladder LS	140	6150670	J-Nut, #10-24
54	6200710	Screw, #8-18 x 3/8" Fillister HD	141	4110331	Base Rear Roller Assy
55	4120460	Main Frame Extrusion, RS	142	3550560	Straight Pin, Base Assy - .312" x 2.88"
56	1807300	Breaker Strip, 6' Length - NOTE: Must be cut to length	143	3421240	Cabinet Roller
57	1807300	Breaker Strip, 6' Length - NOTE: Must be cut to length	144	3450620	Canoe Clip
58	6200010	Screw, #10-12 x 3/4" Pan HD	145	6200050	Screw, #10-12 x 1/2" Pan HD
59	2225701	Top Main Frame	146	0166160	Kickplate, Vented
60	3450120	Grille Spring, 1/4" x 9-5/8"	147	0166020	Kickplate, Black-Solid
61	6200010	Screw, #10-12 x 3/4" Pan HD	148	6220050	Screw Grommet, 1/2" x 5/8"
62	4280210	Compressor Shroud Assy	149	6200010	Screw, #10-12 x 3/4" Pan HD
63	6200770	Screw, #6-32 x 3/4" Pan HD	150	0166050	Kickplate Support
64	6150140	Spring Grip Nut, 1/8"	151	4110333	Base Assembly (w/rollers) - Right or Left
65	3580110	Nameplate	152	3421270	Hinge Bearing, 3/8" x 5/8"
66	6200060	Screw, #8-32 x 1/2" Pan HD		4151221	Cabinet Hinge, Bottom; RH
67	6110010	Bolt, #10-24 x 1/2" Flat Head UC	153	4151222	Cabinet Hinge, Bottom; LH
68	6200390	Screw, #6 x 3/8" T25 Flat Head PH	154	6110070	Bolt, 1/4-20 x 3/4" Spinlock Zinc
69	3540340	Door Hinge, Top RH	155	6240070	Lock Washer, 1/4" SS
	3540350	Door Hinge, Top LH	156	6150200	Nut, 1/4-20 Hex
70	3420070	Hinge Bearing	157	3450560	E-Ring, 7/16"
71	6200070	Screw, #4-24 x 3/8" Flat HD	158	3450550	E-Ring / Klipping, 5/16"
72	0182560	Cabinet Hinge, Top	159	3421260	Door Closer Bearing
73	6110070	Bolt, 1/4-20 x 3/4" Spinlock Zinc		4201111	Door Closer Assembly, RH
74	6110070	Bolt, 1/4-20 x 3/4" Spinlock Zinc		42 01112	Door Closer Assembly, LH
75	3550190	Bottom Hinge Stud	160	DS90	Door Stop-90 Degree
76	6240070	Lock Washer, 1/4" SS		DS105	Door Stop-105 Degree
77	6150200	Nut, 1/4-20 Hex	161	4151241	Door Hinge, Bot; RH
78	0180271	Door Closer Cover, RS		4151242	Door Hinge, Bot; LH
79	0180272	Door Closer Cover, LS	162	6240160	Nylon Washer, 5/8 x .380 x 1/16"
80	6200010	Screw, #10-12 x 3/4" Pan HD	163	3570050	Leveling Leg, #18-3/8 x 1"
81	6240060	Star Washer, 1/4"	164	3450570	Door Closer Cushion
82	3540270	Door Closer	165	3421310	Door Closer Guide
83	3540410	Cabinet Hinge, Bottom RH & LH	166	0165970	Door Closer Support
84	6200210	Screw, #8-32 x 1/2" Flat Head	167	6200010	Screw, #10-12 x 3/4" Pan HD
			168	4200810	Light Diffuser/Fan Shroud Replacement Components; Ref
			169	4200790	Light Diffuser Replacement Components; Fre
			170	6110540	Bolt, #10-24 x 1/2" Flat Socket HD
			171	3450520	Grille Hook

532 COSMETIC VIEW

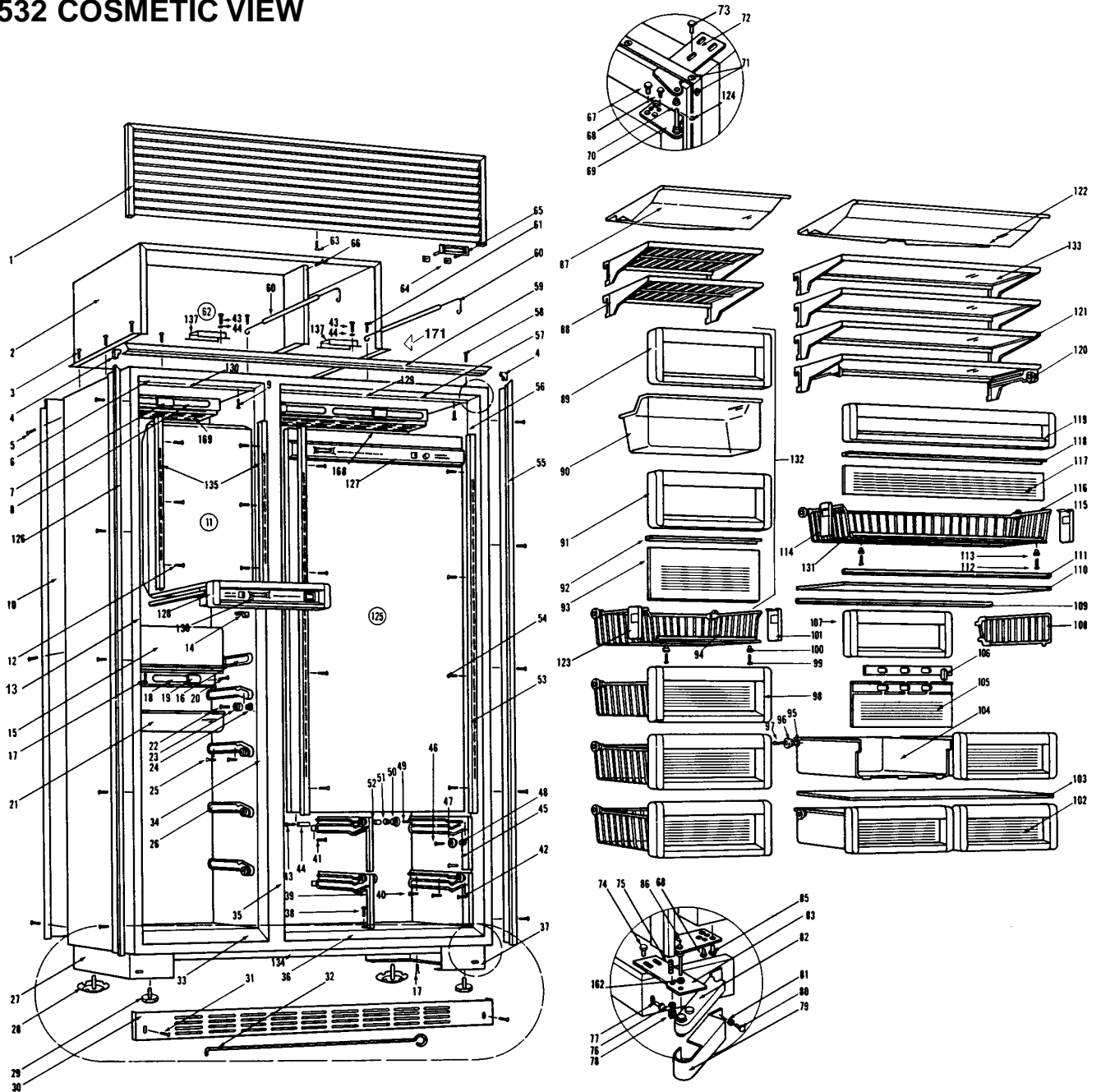

Use prior to Serial No. M824753/P827403

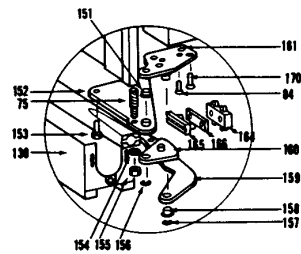
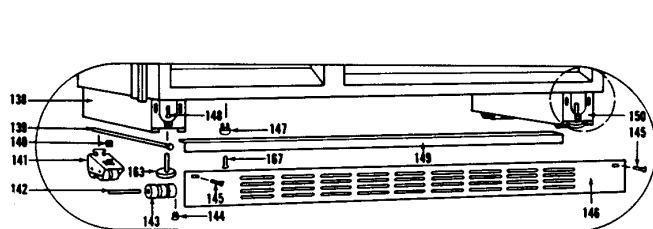

Use after Serial No. M824754/P827404